



rtc[®]

COUPLING TECHNOLOGY

www.rtc-tec.com



046

rtc TYPE



Temperature Range - Temperaturbereich

Nitrile (N) -20°C + 100°C (-4°F + 212°F)
FPM (V) -20°C + 180°C (-4°F + 356°F)

Flow size - Nennweiten

rtc 046.06 6 mm
rtc 046.09 9 mm
rtc 046.13 13 mm
rtc 046.19 19 mm
rtc 046.25 25 mm
rtc 046.30 30 mm
rtc 046.38 38 mm
rtc 046.50 50 mm

Material of Standard Coupler
Material für die Standardversion

Socket body - Brass - Messing
Kupplungsgrundkörper
Sleeve - Hülse Brass - Messing
Springs - Federn Stainless Steel - Edelstahl
Locking Ring - Sprenging Stainless Steel - Edelstahl
Balls - Kugeln Stainless Steel - Edelstahl
Seals - Dichtungen Nitrile (N)

Plug - Nippel Brass - Messing

Max. Working Pressure - Max. Betriebsdruck

Please Check the table below / Bitte Tabelle beachten

Material of Stainless Steel Coupler
Material für die Edelstahlversion

Socket body - Stainless Steel - Edelstahl
Kupplungsgrundkörper
Sleeve - Hülse Stainless Steel - Edelstahl
Springs - Federn Stainless Steel - Edelstahl
Locking Ring - Sprenging Stainless Steel - Edelstahl
Balls - Kugeln Stainless Steel - Edelstahl
Seals - Dichtungen FPM (V)

Plug - Nippel Stainless Steel - Edelstahl

Material of Steel Coupler
Material für die Stahlversion

Socket body - Steel - Stahl
Kupplungsgrundkörper
Sleeve - Hülse Steel - Stahl
Springs - Federn Stainless Steel - Edelstahl
Locking Ring - Sprenging Stainless Steel - Edelstahl
Balls - Kugeln Stainless Steel - Edelstahl
Seals - Dichtungen Nitrile (N)

Plug - Nippel Steel - Stahl



Double Shut-off / Single Shut-off

Working Pressure / Betriebsdruck

Body Size Größe	Brass - Messing		Steel - Stahl		Stainless steel Edelstahl	
	Bar	PSI	Bar	PSI	Bar	PSI
046.06	155	2.250	450	6.500	345	5.000
046.09	155	2.250	310	4.500	275	4.000
046.13	140	1.750	275	4.000	260	3.750
046.19	140	1.750	240	3.500	140	2.000
046.25	125	1.500	140	2.000	140	2.000
046.30	25	350	125	1.750	105	1.500
046.38	25	350	105	1.500	105	1.500
046.50	30	400	105	1.500	35	500

Free Flow

Working Pressure / Betriebsdruck

Body Size Größe	Brass - Messing		Steel - Stahl		Stainless steel Edelstahl	
	Bar	PSI	Bar	PSI	Bar	PSI
046.06	275	4.000	760	11.000	690	10.000
046.09	275	4.000	760	11.000	555	8.000
046.13	275	4.000	760	11.000	555	8.000
046.19	240	3.500	620	9.000	485	7.000
046.25	210	3.000	415	6.000	275	4.000
046.30	70	1.000	345	5.000	210	3.000
046.38	70	1.000	345	5.000	210	3.000
046.50	55	750	275	4.000	70	1.000

Flow Rate vs Pressure Drop Graph

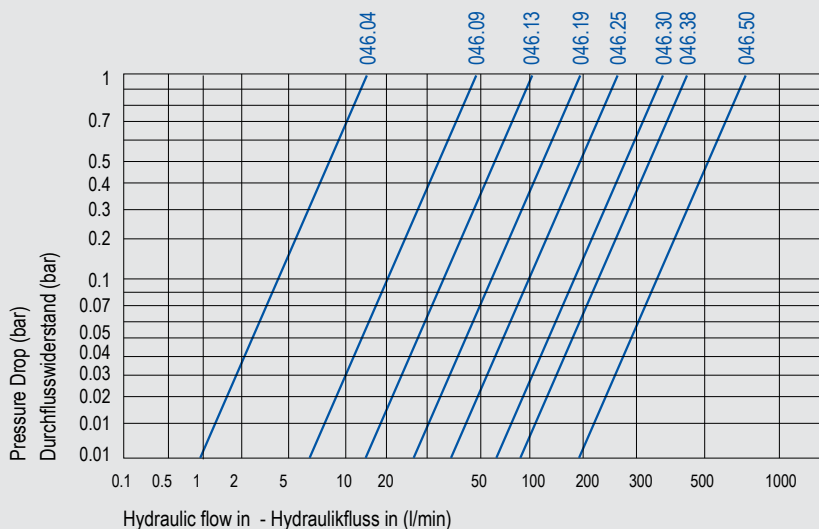

046
rtc TYPE

rtc TYPE 046

Female thread socket with valve / Kupplung mit Innengewinde mit Ventil

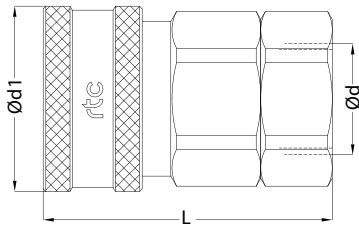
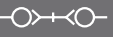

Sockets / Kupplungen	Size / Größe	Order No Brass Bestellnr. Messing	Order No Steel Bestellnr. Stahl	Order No AISI 303 Bestellnr. AISI 303	Ød	Ød1	L	HEX.
06		046.06 SFB 13-MS	046.06 SFB 13-ST	046.06 SFB 13-S3	BSP 1/4	25	44	22
		046.06 SNB 13-MS	046.06 SNB 13-ST	046.06 SNB 13-S3	NPT 1/4	25	44	22
09		046.09 SFB 17-MS	046.09 SFB 17-ST	046.09 SFB 17-S3	BSP 3/8	30	53	24
		046.09 SNB 17-MS	046.09 SNB 17-ST	046.09 SNB 17-S3	NPT 3/8	30	53	24
13		046.13 SFB 21-MS	046.13 SFB 21-ST	046.13 SFB 21-S3	BSP 1/2	35	55	30
		046.13 SNB 21-MS	046.13 SNB 21-ST	046.13 SNB 21-S3	NPT 1/2	35	55	30
19		046.19 SFB 26-MS	046.19 SFB 26-ST	046.19 SFB 26-S3	BSP 3/4	42	63	36
		046.19 SNB 26-MS	046.19 SNB 26-ST	046.19 SNB 26-S3	NPT 3/4	42	63	36
25		046.25 SFB 33-MS	046.25 SFB 33-ST	046.25 SFB 33-S3	BSP 1	50	68	50
		046.25 SNB 33-MS	046.25 SNB 33-ST	046.25 SNB 33-S3	NPT 1	50	70	50
30		046.30 SFB 42-MS	046.30 SFB 42-ST	046.30 SFB 42-S3	BSP 1-1/4	55	90	50
		046.30 SNB 42-MS	046.30 SNB 42-ST	046.30 SNB 42-S3	NPT 1-1/4	55	90	50
38		046.38 SFB 48-MS	046.38 SFB 48-ST	046.38 SFB 48-S3	BSP 1-1/2	69	83	60
		046.38 SNB 48-MS	046.38 SNB 48-ST	046.38 SNB 48-S3	NPT 1-1/2	69	83	60
50		046.50 SFB 60-MS	046.50 SFB 60-ST	046.50 SFB 60-S3	BSP 2	89	105	86
		046.50 SNB 60-MS	046.50 SNB 60-ST	046.50 SNB 60-S3	NPT 2	89	105	86

rtc TYPE 046

Female thread socket without valve / Kupplung mit Innengewinde ohne Ventil

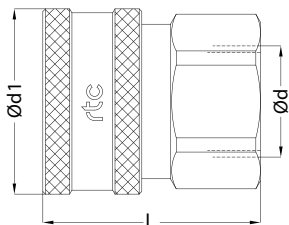

Sockets / Kupplungen	Size / Größe	Order No Brass Bestellnr. Messing	Order No Steel Bestellnr. Stahl	Order No AISI 303 Bestellnr. AISI 303	Ød	Ød1	L	HEX.
06		046.06 SFF 13-MS	046.06 SFF 13-ST	046.06 SFF 13-S3	BSP 1/4	25	34	22
		046.06 SNF 13-MS	046.06 SNF 13-ST	046.06 SNF 13-S3	NPT 1/4	25	34	22
09		046.09 SFF 17-MS	046.09 SFF 17-ST	046.09 SFF 17-S3	BSP 3/8	30	38	24
		046.09 SNF 17-MS	046.09 SNF 17-ST	046.09 SNF 17-S3	NPT 3/8	30	38	24
13		046.13 SFF 21-MS	046.13 SFF 21-ST	046.13 SFF 21-S3	BSP 1/2	35	41	30
		046.13 SNF 21-MS	046.13 SNF 21-ST	046.13 SNF 21-S3	NPT 1/2	35	41	30
19		046.19 SFF 26-MS	046.19 SFF 26-ST	046.19 SFF 26-S3	BSP 3/4	42	44	36
		046.19 SNF 26-MS	046.19 SNF 26-ST	046.19 SNF 26-S3	NPT 3/4	42	44	36
25		046.25 SFF 33-MS	046.25 SFF 33-ST	046.25 SFF 33-S3	BSP 1	50	50	50
		046.25 SNF 33-MS	046.25 SNF 33-ST	046.25 SNF 33-S3	NPT 1	50	50	50
30		046.30 SFF 42-MS	046.30 SFF 42-ST	046.30 SFF 42-S3	BSP 1-1/4	55	58	50
		046.30 SNF 42-MS	046.30 SNF 42-ST	046.30 SNF 42-S3	NPT 1-1/4	55	58	50
38		046.38 SFF 48-MS	046.38 SFF 48-ST	046.38 SFF 48-S3	BSP 1-1/2	69	66	63
		046.38 SNF 48-MS	046.38 SNF 48-ST	046.38 SNF 48-S3	NPT 1-1/2	69	66	63
50		046.50 SFF 60-MS	046.50 SFF 60-ST	046.50 SFF 60-S3	BSP 2	89	63	82
		046.50 SNF 60-MS	046.50 SNF 60-ST	046.50 SNF 60-S3	NPT 2	89	63	82



Female thread plug with valve / Nippel mit Innengewinde mit Ventil

TYPE 046

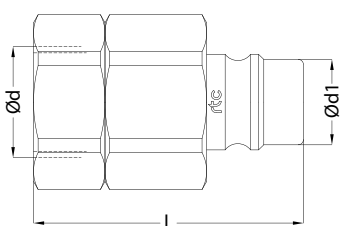

Plug / Nippel	Size / Größe	Order No Brass Bestellnr. Messing	Order No Steel Bestellnr. Stahl	Order No AISI 303 Bestellnr. AISI 303	Ød	Ød1	L	HEX.
	06	046.06 PFB 13-MS	046.06 PFB 13-ST	046.06 PFB 13-S3	BSP 1/4	11	43	22
		046.06 PNB 13-MS	046.06 PNB 13-ST	046.06 PNB 13-S3	NPT 1/4	11	43	22
	09	046.09 PFB 17-MS	046.09 PFB 17-ST	046.09 PFB 17-S3	BSP 3/8	13	52	24
		046.09 PNB 17-MS	046.09 PNB 17-ST	046.09 PNB 17-S3	NPT 3/8	13	52	24
	13	046.13 PFB 21-MS	046.13 PFB 21-ST	046.13 PFB 21-S3	BSP 1/2	16	51	30
		046.13 PNB 21-MS	046.13 PNB 21-ST	046.13 PNB 21-S3	NPT 1/2	16	51	30
	19	046.19 PFB 26-MS	046.19 PFB 26-ST	046.19 PFB 26-S3	BSP 3/4	23.5	60	36
		046.19 PNB 26-MS	046.19 PNB 26-ST	046.19 PNB 26-S3	NPT 3/4	23.5	60	36
	25	046.25 PFB 33-MS	046.25 PFB 33-ST	046.25 PFB 33-S3	BSP 1	30	66	50
		046.25 PNB 33-MS	046.25 PNB 33-ST	046.25 PNB 33-S3	NPT 1	30	68	50
	30	046.30 PFB 42-MS	046.30 PFB 42-ST	046.30 PFB 42-S3	BSP 1-1/4	36	87	50
		046.30 PNB 42-MS	046.30 PNB 42-ST	046.30 PNB 42-S3	NPT 1-1/4	36	87	50
	38	046.38 PFB 48-MS	046.38 PFB 48-ST	046.38 PFB 48-S3	BSP 1-1/2	43.5	79	50
		046.38 PNB 48-MS	046.38 PNB 48-ST	046.38 PNB 48-S3	NPT 1-1/2	43.5	79	50
50	046.50 PFB 60-MS	046.50 PFB 60-ST	046.50 PFB 60-S3	BSP 2	57	100	86	
	046.50 PNB 60-MS	046.50 PNB 60-ST	046.50 PNB 60-S3	NPT 2	57	100	86	



Female thread plug without valve / Nippel mit Innengewinde ohne Ventil

TYPE 046

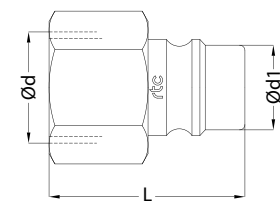

Plug / Nippel	Size / Größe	Order No Brass Bestellnr. Messing	Order No Steel Bestellnr. Stahl	Order No AISI 303 Bestellnr. AISI 303	Ød	Ød1	L	HEX.
	06	046.06 PFF 13-MS	046.06 PFF 13-ST	046.06 PFF 13-S3	BSP 1/4	11	31	16
		046.06 PNF 13-MS	046.06 PNF 13-ST	046.06 PNF 13-S3	NPT 1/4	11	31	16
	09	046.09 PFF 17-MS	046.09 PFF 17-ST	046.09 PFF 17-S3	BSP 3/8	13	35	22
		046.09 PNF 17-MS	046.09 PNF 17-ST	046.09 PNF 17-S3	NPT 3/8	13	35	22
	13	046.13 PFF 21-MS	046.13 PFF 21-ST	046.13 PFF 21-S3	BSP 1/2	16	37	25
		046.13 PNF 21-MS	046.13 PNF 21-ST	046.13 PNF 21-S3	NPT 1/2	16	37	25
	19	046.19 PFF 26-MS	046.19 PFF 26-ST	046.19 PFF 26-S3	BSP 3/4	23.5	44	30
		046.19 PNF 26-MS	046.19 PNF 26-ST	046.19 PNF 26-S3	NPT 3/4	23.5	44	30
	25	046.25 PFF 33-MS	046.25 PFF 33-ST	046.25 PFF 33-S3	BSP 1	30	54	38
		046.25 PNF 33-MS	046.25 PNF 33-ST	046.25 PNF 33-S3	NPT 1	30	54	38
	30	046.30 PFF 42-MS	046.30 PFF 42-ST	046.30 PFF 42-S3	BSP 1-1/4	36	57	48
		046.30 PNF 42-MS	046.30 PNF 42-ST	046.30 PNF 42-S3	NPT 1-1/4	36	57	48
	38	046.38 PFF 48-MS	046.38 PFF 48-ST	046.38 PFF 48-S3	BSP 1-1/2	43.5	62	54
		046.38 PNF 48-MS	046.38 PNF 48-ST	046.38 PNF 48-S3	NPT 1-1/2	43.5	62	54
50	046.50 PFF 60-MS	046.50 PFF 60-ST	046.50 PFF 60-S3	BSP 2	57	66	70	
	046.50 PNF 60-MS	046.50 PNF 60-ST	046.50 PNF 60-S3	NPT 2	57	66	70	